

PORTAVALIGIE LATERALE SPECIFICO - SPECIFIC TUBULAR SIDE-CASE HOLDER
 PORTE-VALISES LATÉRAUX SPECIFIQUE - SPEZIFISCHES STAHLROHR-SEITENTRÄGER
 PORTA MALETAS LATERALES ESPECIFICO

BMW R1200GS 2006 ADVENTURE

ISTRUZIONI DI MONTAGGIO - MOUNTING INSTRUCTIONS
 INSTRUCTIONS DE MONTAGE - BAUANLEITUNG - INSTRUCCIONES DE MONTAJE

1

SUPPORTO
 SUPPORT
 SUPPORT
 HALTERUNG
 SOPORTE

Q.TY n.2(Dx-Sx)

2

PONTE POSTERIORE
 REAR BRIDGE
 PONT POSTÉRIEURE
 VERBUNDUNGSGROH
 PUENTE TRASERO

Q.TY n.1

3

VITE TBEI M6x50mm
 SCREW M6x50mm
 VIS M6x50mm
 SCHRAUBE M6x50mm
 TORNILLO M6x50mm

Q.TY n.2

4

VITE TCEI M6x15mm
 SCREW M6x15mm
 VIS M6x15mm
 SCHRAUBE M6x15mm
 TORNILLO M6x15mm

Q.TY n.2

5

VITE TCEI M6x50mm
 SCREW M6x50mm
 VIS M6x50mm
 SCHRAUBE M6x50mm
 TORNILLO M6x50mm

Q.TY n.2

6

VITE TBEI M8x55mm
 SCREW M8x55mm
 VIS M8x55mm
 SCHRAUBE M8x55mm
 TORNILLO M8x55mm

Q.TY n.2

7

RONDELLA Ø8x14mm
 WASHER Ø8x14mm
 RONDELLE Ø8x14mm
 SCHEIBE Ø8x14mm
 ARANDELA Ø8x14mm

Q.TY n.4

8

RONDELLA Ø8mm
 WASHER Ø8mm
 RONDELLE Ø8mm
 SCHEIBE Ø8mm
 ARANDELA Ø8mm

Q.TY n.2

9

RONDELLA Ø6mm
 WASHER Ø6mm
 RONDELLE Ø6mm
 SCHEIBE Ø6mm
 ARANDELA Ø6mm

Q.TY n.2

10

DADO A.B. M8
 BOLT M8
 ECROU M8
 MUTTER M8
 TUERCA M8

Q.TY n.2

11

DADO M8
 BOLT M8
 ECROU M8
 MUTTER M8
 TUERCA M8

Q.TY n.2

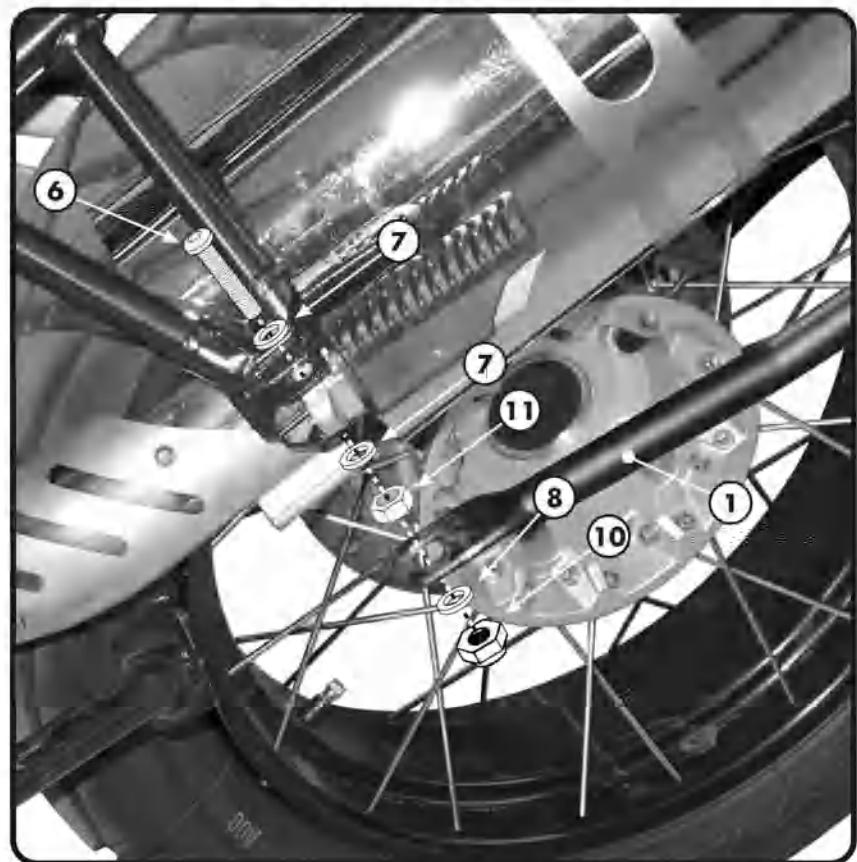
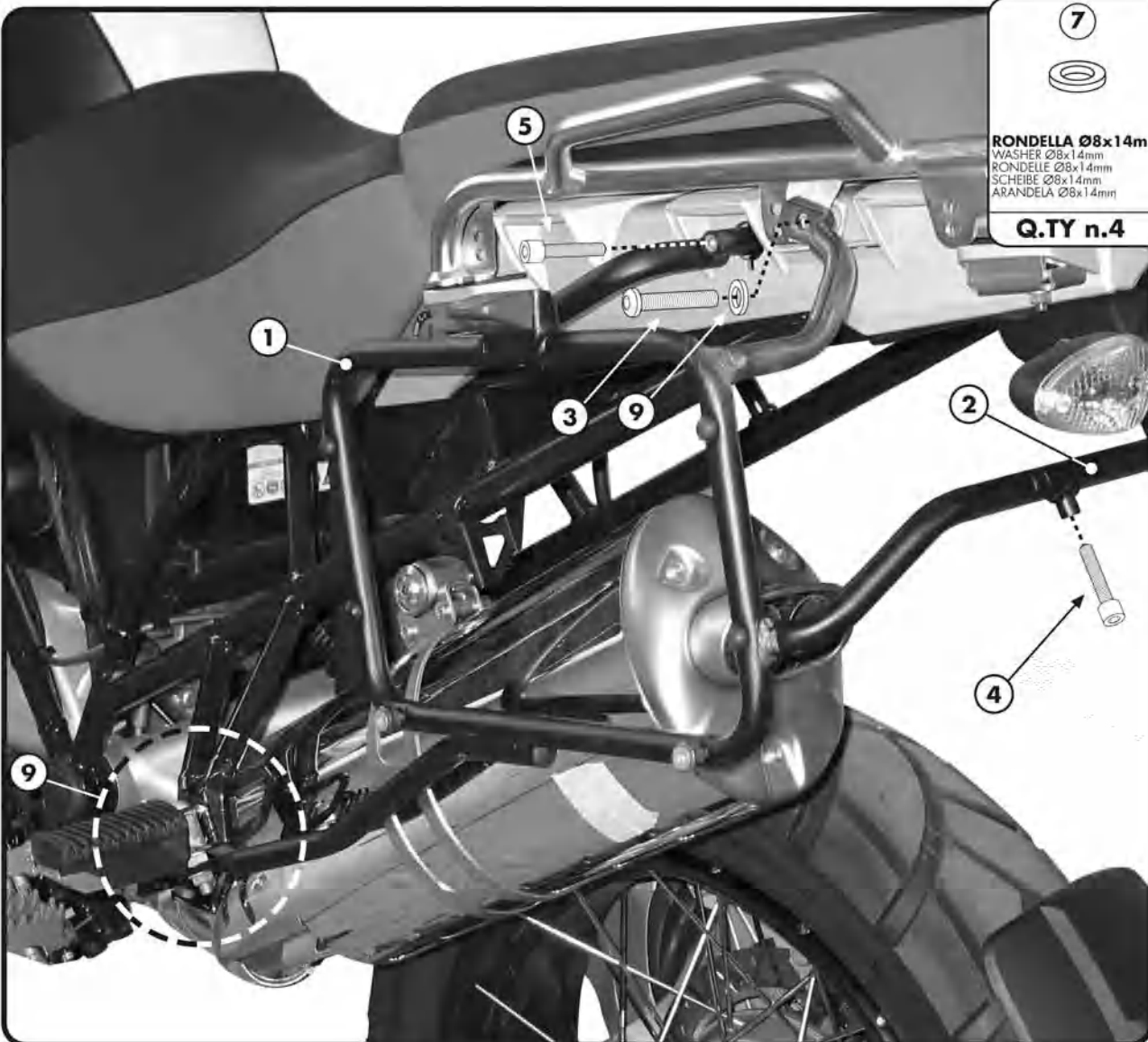

PORTAVALIGIE LATERALE SPECIFICO - SPECIFIC TUBULAR SIDE-CASE HOLDER
 PORTE-VALISES LATÉRAUX SPÉCIFIQUE - SPEZIFISCHES STAHLROHR-SEITENTRÄGER
 PORTA MALETAS LATERALES ESPECÍFICO

BMW R1200GS 2006 ADVENTURE

ISTRUZIONI DI MONTAGGIO - MOUNTING INSTRUCTIONS
 INSTRUCTIONS DE MONTAGE - BAUANLEITUNG - INSTRUCCIONES DE MONTAJE

I ISTRUZIONI DI MONTAGGIO

1. MONTARE IL PORTAVALIGIA LATERALE COME INDICATO IN FOTO A;
2. FISSARE IL PORTAVALIGIA ALLA PEDALINA DEL PASSEGGERO COME INDICATO IN FOTO B;
3. ULTIMARE IL MONTAGGIO CONTROLLANDO CHE TUTTE LE VITI SIANO SERRATE BENE.

GB MOUNTING INSTRUCTIONS

1. MOUNT THE SIDE CASE HOLDER AS SHOWN IN PICTURE A;
2. FIX THE SUPPORT TO THE PASSENGER'S FOOTREST AS SHOWN IN PICTURE B;
3. LASTLY CHECK THAT ALL SCREWS HAVE BEEN TIGHTENED.

F INSTRUCTIONS DE MONTAGE

1. MONTER LES SUPPORTS VALISES COMME INDIQUE SUR LA PHOTO A;
2. FIXER LES SUPPORTS VALISES AUX REPOSE-PIEDS PASSAGER COMME INDIQUE SUR LA PHOTO B;
3. TERMINER LE MONTAGE EN SERRANT BIEN TOUTES LES VIS.

D BAUANLEITUNG

1. MONTIEREN SIE DEN SEITENKOFFERTRÄGER WIE IM BILD A BESCHRIEBEN;
2. BEFESTIGEN SIE DEN SEITENKOFFERTRÄGER AN DEN BEIFÄHRER-FUßRASTEN WIE IM BILD B BESCHRIEBEN;
3. ZULETZT ZIEHEN SIE ALLE SCHRAUBEN FEST.

ES

INSTRUCCIONES DE MONTAJE

1. MONTAR EL PORTA MALETAS LATERAL COMO INDICA LA FOTO A;
2. ANCLAR EL PORTAMALETAS A LA ESTRIBERA DEL PASAJERO COMO INDICA LA FOTO B;
3. TERMINAR APRETANDO TODOS LOS TORNILLOS